

NOVA LUCE

9060184 & 9060185

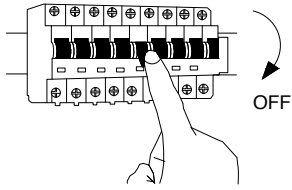

1. Turn off the general switch

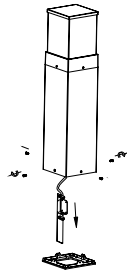

2. Untight the side screws

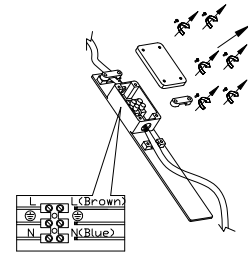

3. Untight the screws to
Connect the wires

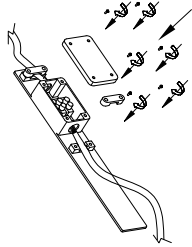

4. Apply the cap

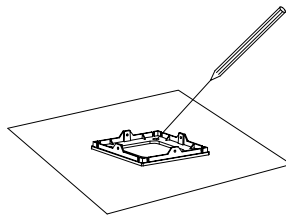

5. Mark the area

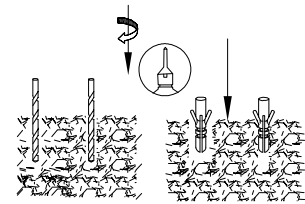

6. Drill on the marked areas
& Apply plastic anchors

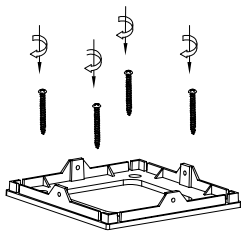

7. Apply the screws

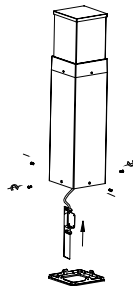

8. Tight the side screws

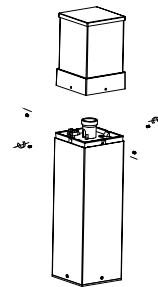

9. Untight the side screws

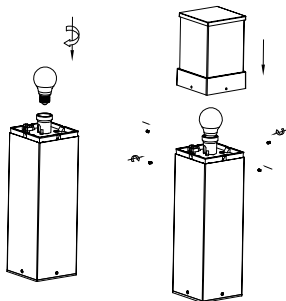

10. Install the bulb, apply the cap
With the side screw

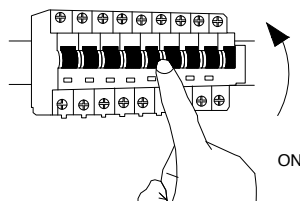

11. Turn on the general switch

