

NOVA LUCE

9100917, 9100918

1

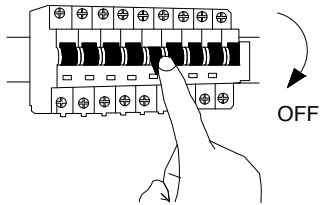

Turn off the general switch

2

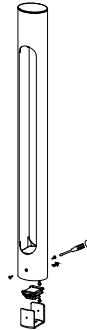

Dismantle parts to expose wires

3

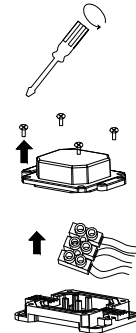

Untie the screws to expose parts

4

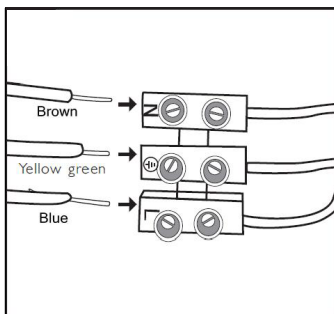

Connect wires

5

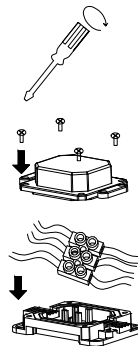

Tie up screws to fix parts together

6

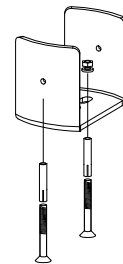

Drill holes apply plastic anchors
Tie up screws to make it stable

7

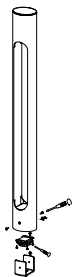

Apply side screws by tying them up

8

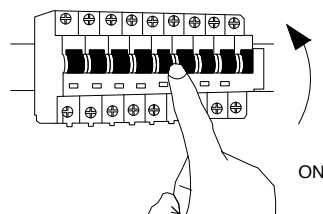

Turn off the general switch

9

