

NOVA LUCE

9030889

PART A

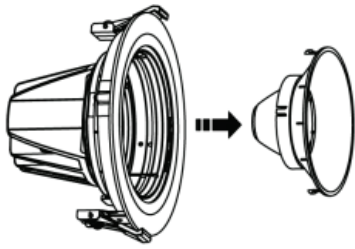

1. Remove the reflector

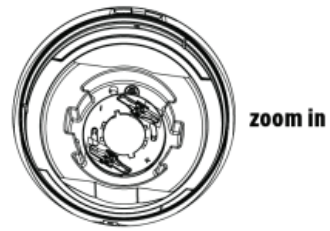

2. Insert the bulb

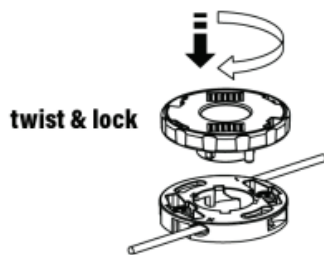

2.a. For the installation of the bulb to be correct, first twist & lock into place



2.b. Then proceed into insertation

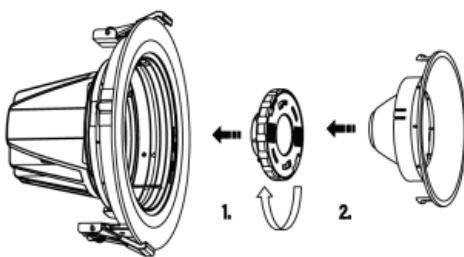

5. Apply the reflector

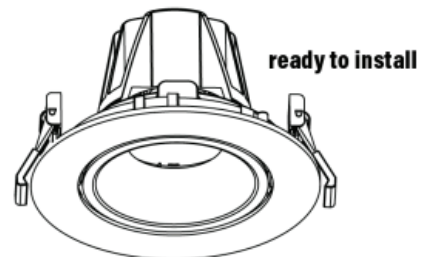

6. Ready to install
& proceed to Part B

NOVA LUCE

9030889

PART B

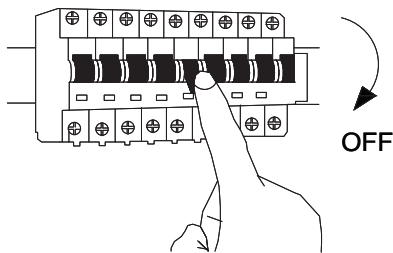

1. Turn off the general Switch

Ø160	Ø143	↑ A 93mm	max. 700mA
Ø190	Ø176	↑ A 116mm	max. 900mA

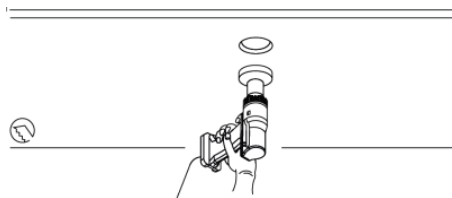

2. Create a CutOut

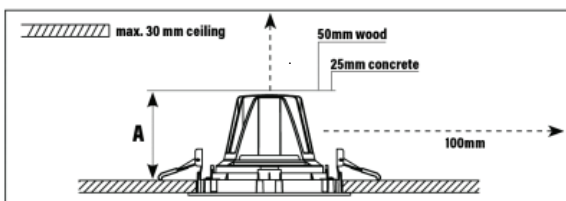

3. Take into consideration the material you are opening the hole

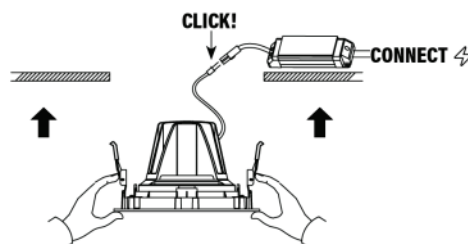

4. Insert the luminaire into the opening & plug in the wires

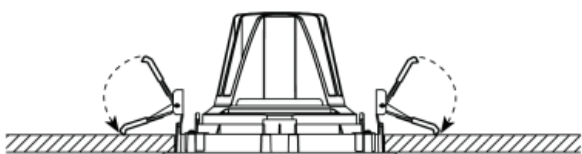

5. Make it steady by fixing it onto place

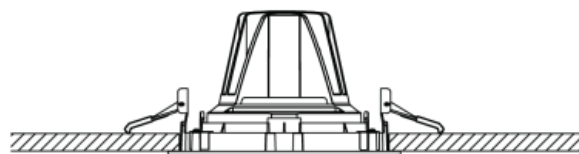

6. Make sure the elastic ears are open

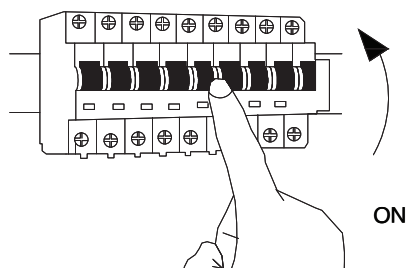

7. Turn on the general Switch

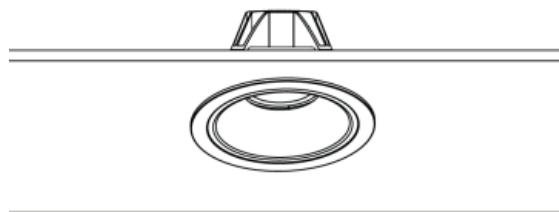

WARNING: The luminaire is not suitable for covering with thermally insulating material

