

# NOVA LUCE

870026

1

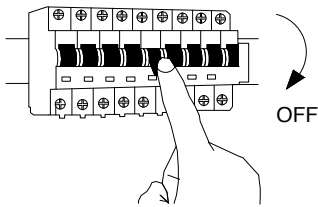

Turn off the general switch

2

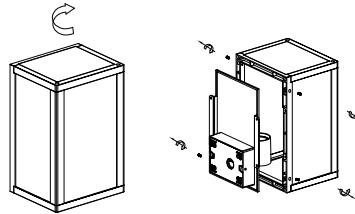

Dismantle the product

3

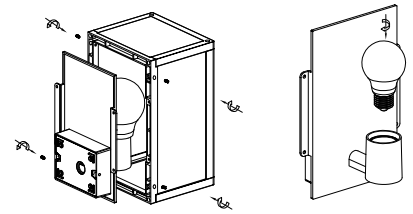

Remove the nuts  
& Apply the bulb

4

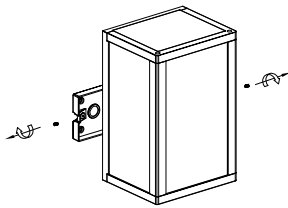

Remove the side nuts

5

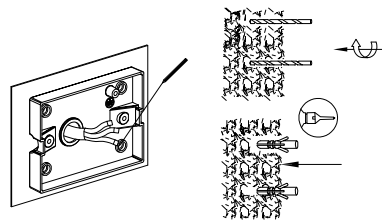

Mark where to drill  
& Drill holes, apply plastic anchors

6

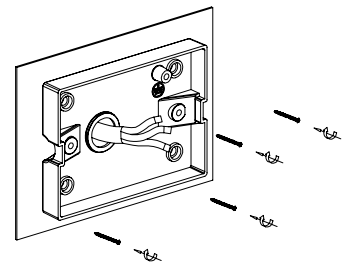

Apply screws

7

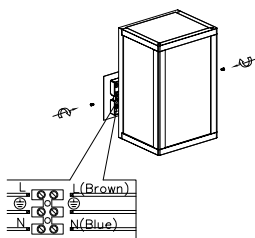

Connect wires  
& Apply the side screws

8

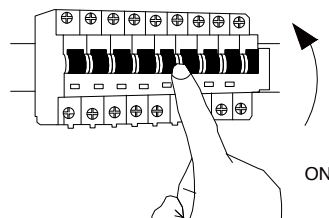

Turn on general switch

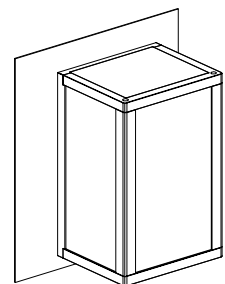

# NOVA LUCE

870026

10

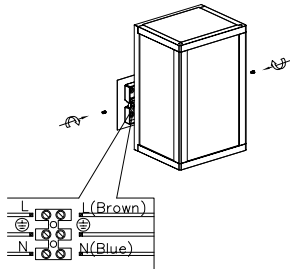

Connect the wires  
& Apply the side nuts

11

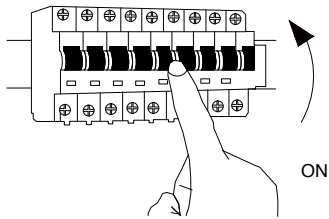

Turn on the general switch

