

NOVA LUCE

9186939

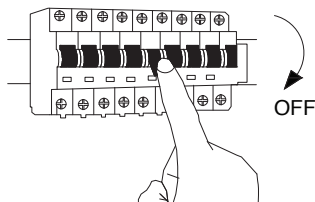

1. Turn off the general switch

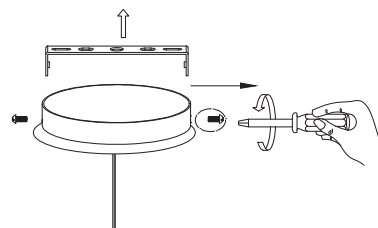

2. Unscrew the screws and remove the metal base.

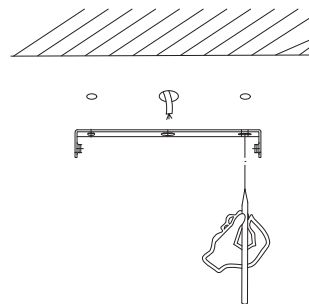

3. Mark with a pencil on the wall to open holes.

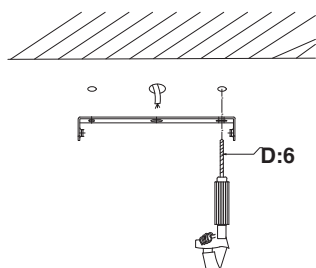

4. Open holes with the drill.

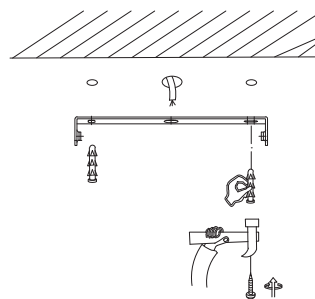

5. Put the washers and screws and tighten the screws.

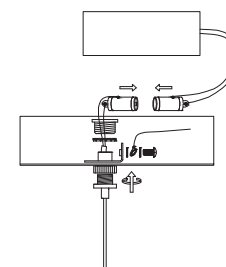

6. Connect with the driver.

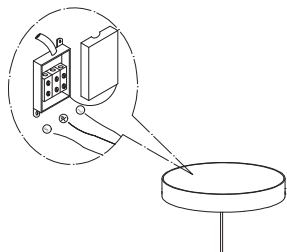

7. Connect the wires.

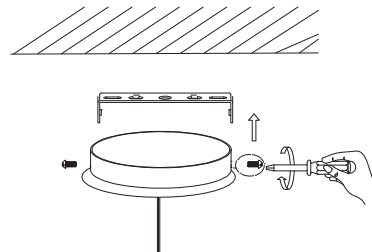

8. Screw the side screws into the metal base.

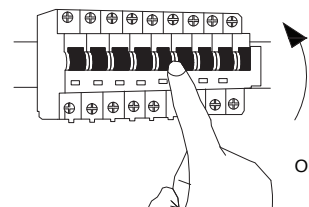

9. Turn on the general switch.

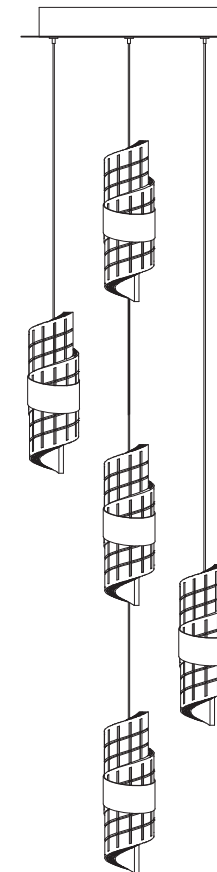

1. This light fitting operates at a normal supply voltage of 220-240V.
2. When changing the bulb or fuses, always switch off at the mains and allow the old bulb to cool down before handling.